

SWITCH GUARD type-1

MAIN MODEL : HONDA
RIGHT SIDE HANDLE SWITCH HOLDER (HOUSING)

APPLICATION :

GROM (61 / 75 / 92) / HRC GROM (GROM 5) / MONKEY 125 (JB02/03) / CT125 HUNTER CUB (JA55) , etc

CODE :

(RED RD) 756-9031020 / (BLACK BK) 756-9031050 / (GUNMETAL GRAY GM) 756-9031090

●Thank you for purchasing Kitaco product. Read and understand the instruction before installing.

ATTENTION (MUST READ)

- This product is cover for not to malfunction engine stop switch. Do not use for other purposes.
 - This product is designed and made exclusive for application models, do not use other models. Do not modify the way which is not listed or it will cause damage and trouble.
 - We are not responsible for violation of law or damages and accidents caused by assembling mistake and improper setting.
 - Please ask authorized mechanic for assembling and setting.
 - This instruction sheet is for the instruction for genuine condition.
 - Refer to the manufacturer service manual when installation.
 - Bolts and nuts may get loosen by engine vibration. (Double sided tape may peel off because of the usage enviroment and ages.)Make sure not to loosen any bolts and nuts before driving.
- ※Metal/resin/alumite products get discolored/rust for ages as well as how to use.
Please understand when using.

PACKING LIST			
NAME		CODE	QTY
SWITCH GUARD type-1	(RD/BK/GM)	-	x1
DOUBLE SIDED TAPE	① W5x35x0.8T	756-9031002	x1
	② W5x30x0.8T	756-9031003	x1
	③ W5x15x0.8T	756-9031004	x1

ATTENTION WHEN USING!

Please check clearance. It might interrupt by models.

HOW TO INSTALL (This instruction is just a reference.)

●Ready to stick

- Make sure where to stick by matching engine stop switch position before installation.
- Install to right side handle switch holder (housing) positon with attached double sided tape as following attention below.

●How to stick switch guard

- 1) Clean up grease, wax, etc from the installation surface.
- 2) Stick only attached double sided tape to specified positon as illustration below.
- 3) Remove 1cm~half of the release paper to decide where to stick, then remove rest of the release papar to stick firmly. (Do not apply finger print or grease to sticking surface. The tape is strong Once stick firmly, it difficult to peel and might cause of break.
- 4) After decide installation position, press down the tape position.

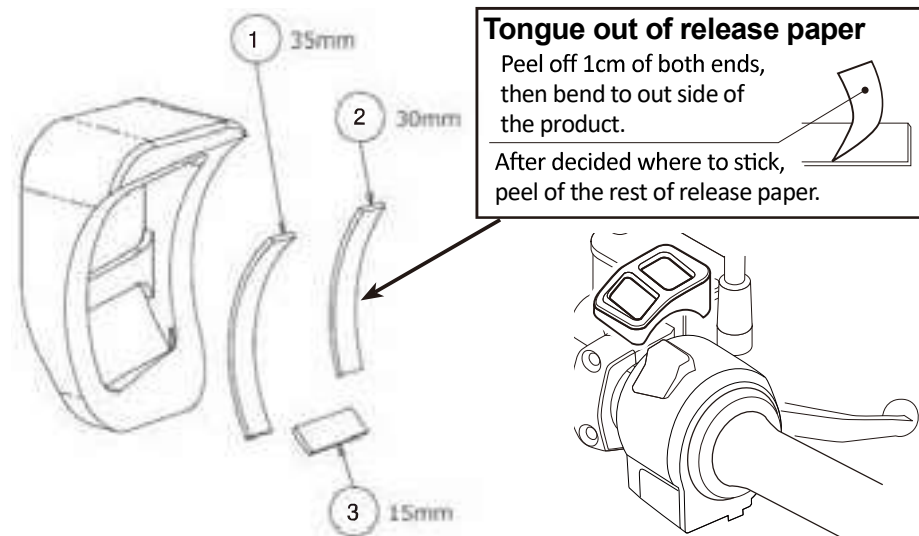

HOW TO TAKE CARE

ATTENTION WHEN INATALLING / USING

- This product is for not to malfunction engine stop switch. Unable to protect from scratches or damages by falling. Do not use for other purposes.
- Ages, engine vibration and climate may cause of low stickness. Please understand before installtion.
- Tapes cannot reusable after once stick firmly.