

## WIDE CHAIN GUIDE PLATE

CODE	683-1452400
APPLICATION	GROM (JC92) / '21HRC GROM (GROM 5)
ATTENTION	According to models, the large O.D. drive sprocket teeth is different.

● Thank you for purchasing Kitaco product.

Read and understand the instruction before installing.

### ATTENTION! (MUST READ)

- This product is designed and made exclusive for application vehicles, do not use other models. Do not modify the way which is not listed or it will cause damage and trouble.
  - We are not responsible for violation of law or damages and accidents caused by assembling mistake and improper setting.
  - Please ask authorized mechanic for assembling and setting.
  - Bolts and nuts may get loosen by engine vibration. Make sure not to loosen any bolts and nuts before driving.
  - This instruction sheet is for the instruction for genuine condition.
- ※ Metal/resin products get discolored/rust for ages as well as how to use. Please understand when using.

APPLICATION VEHICLE SPECIFICATION	STANDARD DRIVE SPROCKET TEETH	CHAIN SIZE	KITACO GUIDE PLATE COMPATIBLE MAXIMUM TEETH
GROM(JC92) / '21HRC GROM(GROM 5)	15T	420	TILL 17T

### PACKING LIST

NAME	CODE	QTY
WIDE CHAIN GUIDE PLATE	-	1

※ Refer to the manufacturer service manual when installation.

- Remove genuine chain guide from drive sprocket cover.  
(The chain guide might be fixed to drive sprocket cover, remove the projection tip to remove chain guide.)

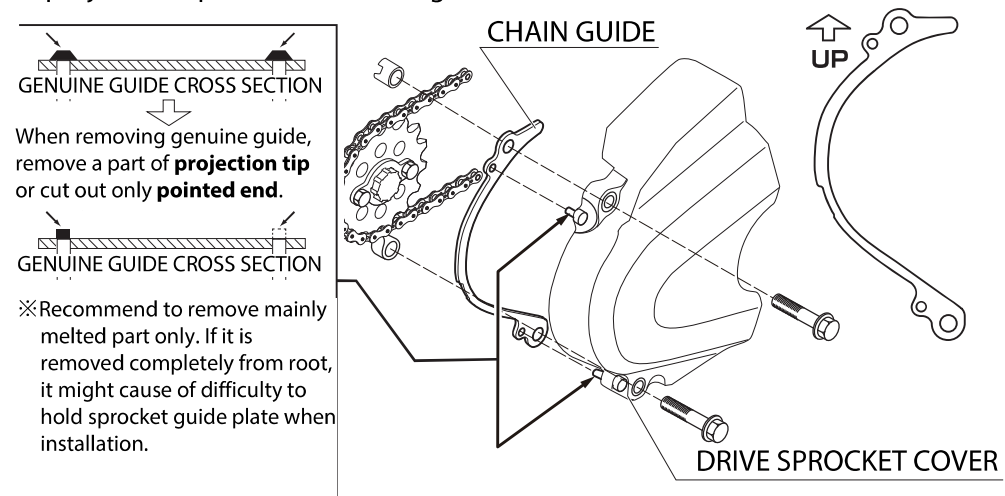

※ This product is not to protect the interface of drive chain, crank case and etc. If the drive chain does not stable, adjust tension regularly.