

STEP BOARD			
APPLICATION	ADV160 (KF54)		
CODE	(BLACK ALUMITE) 538-1461050	(SILVER ALUMITE) 538-1461060	

● Thank you for purchasing Kitaco product. Read and understand the instruction before installing.

ATTENTION (MUST READ)

- This product is designed and made exclusive for application vehicles, do not use other models. Do not modify the way which is not listed or it will cause damage and trouble.
- We are not responsible for violation of law or damages and accidents caused by assembling mistake and improper setting.
- Please ask authorized mechanic for assembling and setting.
- Refer to the manufacturer service manual when installation.
- Bolts and nuts may get loosen by engine vibration. Make sure not to loosen any bolts and nuts before driving.
- This instruction sheet is for the instruction for genuine condition.



There might be burr on the edge. Please be careful of it and wear grooves, etc to protect when installation.



This product cannot transform freely because of the material characteristic. If the curb does not matched, please modify to install.



Make sure not to forget tighten bolts. (It might cause of parts fell and break.)



Leaving aluminum products cause of surface oxidation. Please polish regularly with compound for aluminum or wax, etc.

PACKING LIST

FIGURE	NAME	CODE	QTY
A	STEP BOARD (R)	-	x1
B	STEP BOARD (L)	-	x1
C	TAPPING SCREW (SUS) M4x20	046-0594020	x10
D	TRUSS HEAD SCREW (SUS) M4x15	046-0510015	x10
E	WELNUT C-440	678-0500512	x10

HOW TO INSTALL

○ Be careful not to make scratch to vehicle by this product.

■ REMOVE

- 1) Remove genuine floor mat.
- 2) Remove some of side cover installation screw (4pcs on one side).

■ READY

- 3) Assemble Kitaco step board with (D) truss head screw and (E) welnut temporarily to specified position. (Refer to the illustration.)

▲ ATTENTION!

※ Do not install welnut to vehicle side because it is easy to fell when tightening bolt. Please install temporarily to step side.

■ INSTALL

- 4) Place step board to vehicle.
- ※ Firstly, place the bottom side (flat surface, then front side. (At this time, front side is floating but it is not a problem.)
- 5) Holding down Kitaco step board floating place, tighten from outer side (C) tapping screw following tightening order. (Tighten with side cover together.)

▲ ATTENTION!

※ Must to tighten from (C) tapping screw side as following tightening order to fix. Tighten from (E) welnut and (D) truss screw might be unable to install correctly.

- 6) Tighten (D) truss screw firmly.
- 7) Tighten each bolts firmly to finish installation.

※ Step board out side floating situation. (before fixed)

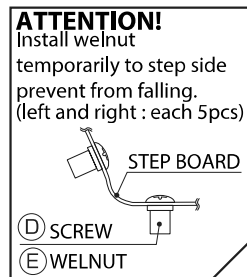

ATTENTION!
Install welnut temporarily to step side prevent from falling. (left and right : each 5pcs)

ATTENTION!

Tighten with following tightening order as below while **holding down Kitaco step board.**

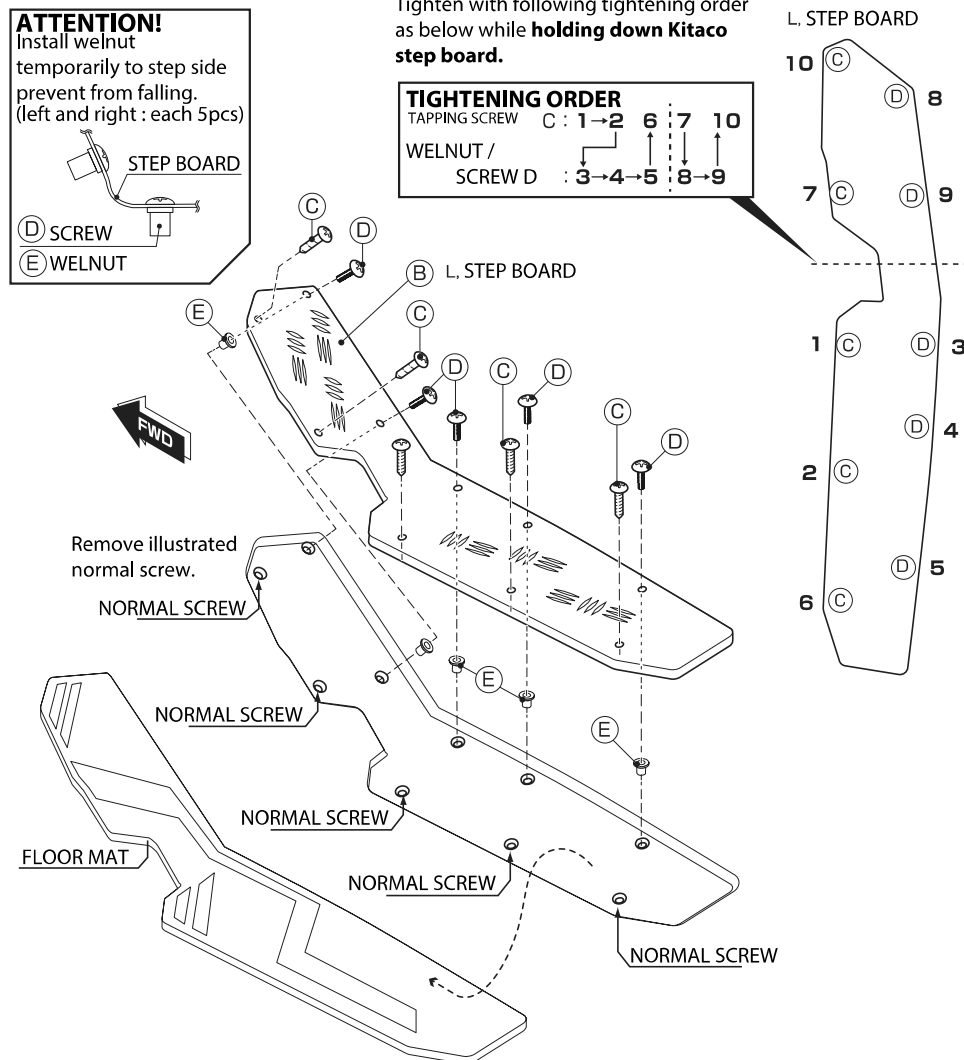
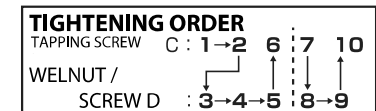

L. STEP BOARD

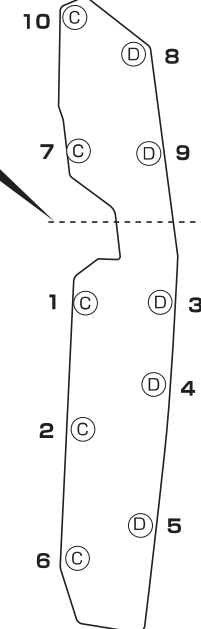

220803 Y-H
〒 577-0015
3-8-13 NAGATA, HIGASHI-
OSAKA, OSAKA, JAPAN

株式会社 中ノ