

GEARS SHOCK ABSORBER (No,1/2)	APPLICATION : CL250/500 (MC57/PC68)
CODE : 520-1870100	
REMARK : SOLD IN PAIRS	

Thank you for purchasing Kitaco product. Read and understand the instruction before installing.

ATTENTION (MUST READ)

- This instruction sheet is for the instruction for OEM condition.
- Please ask authorized mechanic for assembling and setting. Ask a specialist at specialty shop if you do not understand the role of the surrounding parts.
- We are not responsible for violation of law or damages and accidents caused by assembling mistake and improper setting.
- After installation, steering stability has changed compare to the normal rear shock. Please ride safely.
- Refer to the manufacturer service manual when installation.
- Bolts and nuts may get loosen by engine vibration. Make sure not to loosen any bolts and nuts before driving.
- Do not modify the way which is not listed or it will cause damage and trouble.
- ※ Metal/resin products get discolored/rust for ages as well as how to use. Please understand when using.

HOW TO INSTALL

※ If there is a hard degradation like a blem, fatigue and wear etc on the reuse parts, please change to new ones.

※ Remove muffler for not to touch each other when temporarily installing rear shock.

- 1) Stable vehicle by maintenance stand, etc.
- 2) Refer to the service manual when removing/installing outer cowls.
- 3) Remove OEM rear shock and install GEARS one.

※ Tighten upper/lower mount bolt (nut) with specified torque.

○ UPPER/LOWER BOLT :

M6 BOLT : 9N·m (0.9kgf·m)

M8 BOLT : 21N·m (2.1kgf·m)

※ Apply grease to vehicle side mount bolt and bush when installing.

- 4) Adjust each parts and make sure not to loosen any parts before riding.

※ For more details, refer to the illustration below and how to adjust.

ATTACHED PARTS	
NAME	QTY
HOOK WRENCH for Gears	1
WASHER	4

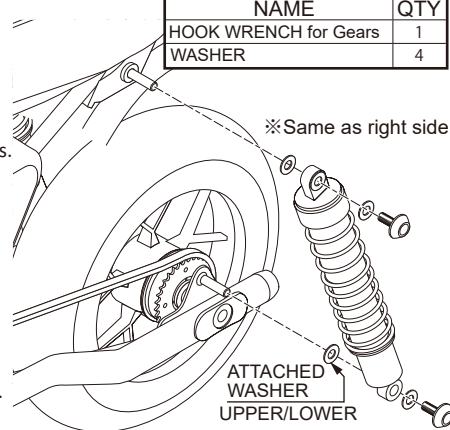

THE GAS DISPOSAL VALVE

ATTENTION! PROHIBITION OF DISASSEMBLE AND MODIFICATION (DON'T TOUCH)
Unable to change the oil amount and gas pressure of this product. Do not touch the gas disposal hexagon valve of the upper body. Once loosen hexagon valve, the gas coming out and unable to use again because of the deterioration of shock performance. We are not encapsulation of gas.

ATTENTION! HOW TO DISPOSAL
The high pressure gas is encapsulated in this shock. Extract gas by gas disposal valve and do a scrap processing when disposal. If dispose without extract the gas, it may cause of explosion. Dispose this rear shock is dangerous, please ask to the maintenance shop, dismantler, etc.

PRELOAD ADJUSTMENT (NON-STEP)
Adjust the position of spring sheet by hook wrench, etc.

REBOUND ADJUSTMENT (STRETCH SIDE) DIAL (14 STEPS) [Do not use out of the range.]

VEHICLE HEIGHT ADJUSTMENT (NON-STEP)
Allowable adjusting range [Do not use out of the range.]
• From basic OEM height ± (depending on models)
Turn lower side (screw part) to adjust the height.
※ After adjustment, fix with lock nut.

+ : Slow down the rebound speed (slower return)

- : Speed up the rebound speed (faster return)

HOW TO ADJUST EACH PARTS



- ※ Please park safe place when adjusting.
- ※ Clean the dust and water from adjustment place before adjusting.
- ※ Too much re-tightening the adjustment dial may cause of hard wear and oil leak.

■ PRELOAD ADJUSTMENT (INITIAL)

- Adjust spring compression while initial condition for matches rider and luggage weight.
- Use hexagon and attached specified wrench when adjusting preload.
- ※ Must to set up with tire floated.

- 1) Loosen set screw on the side of preload adjust seat by hexagon wrench.

- 2) Apply silicone lubricant spray for protect body screw part. Must to clean up after adjustment.

- 3) Adjust with specified wrench to turn preload adjust seat. Turn to the right to make it hard, and turn to the left to make it soft.

- 4) Finally, tighten set screw lightly (0.2~0.3kgf·m) to lock.

※ Be careful of breaking screw part by too much tightening.

※ The shrinkage amount while riding that compared to the one while jacked up is called sag. Around 1/3 of all stroke is roughly estimated.

※ Yet insure the 5mm of the sag when it is empty.

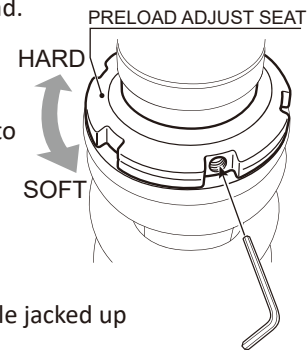

■ VEHICLE HEIGHT ADJUSTMENT

• Please do this adjustment if the vehicle height is different from OEM condition after preload adjustment.

• Vehicle height adjustment function is able to ± (plus/minus) from basic OEM length (depending on models).

• Please do adjustment with the shock is removed from vehicle.

- 1) Loosen lock nut by turning to the left.

- 2) Turn pillow ball part to the left to raise and right to lower the height.
- ※ Do not use out of the adjustment range. (Follow the adjustment range below.)

- 3) Tighten lock nut to install to vehicle.

※ Lock nut for height adjustment might loosen by vibration, etc. Please tighten additionally regularly.

● ADJUSTMENT RANGE : -2~+5mm (Basic OEM length : 0)

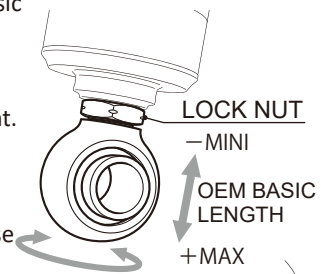

■ STRETCH SIDE REBOUND ADJUSTMENT 14 STEPS

• Make the speed of stretching (rebound) suspension slower when riding.

• Adjust with dial or minus driver.

• Turn to the (+) direction for harder rebound (the speed of stretch side is slower).

• Turn to the (-) direction for softer rebound (the speed of stretch side is faster).

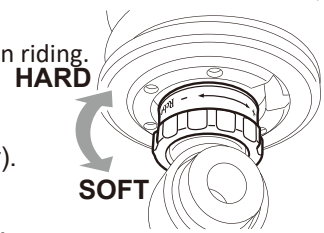

AFTER INSTALLATION

• After installation, oil come out a little on the shaft, but it is not oil leaking. It is grease that applied when manufacturing. If there is too much, wipe it off with soft cloth.

• Make sure not to loosen any bolts and nuts regularly.

• If it is loosen, tighten to specified torque.

GEARS SHOCK ABSORBER (No,2/2)	APPLICATION : CL250/500 (MC57/PC68)
CODE : 520-1870100	
REMARK : SOLD IN PAIRS	

INITIAL (SHIPPING) SETTING		
FIGURE	MODEL	CL250
-	Type	TWIN
1	FULL LENGTH (eye to eye)	386 mm
2	VEHICLE ADJUSTMENT RANGE	-2 ~ +5 mm
3	STROKE	73 mm
-	SPRING RATE	2.0 Kg/mm
-	SPRING FREE LENGTH	200 mm
4	PRELOAD SET POSITION WHEN SHIPPING	10 mm
5	SPRING SET LENGTH	190 mm
6	REBOUND ADJUSTER STEPS	14 CLICKS
	INITIAL POSITION	7 CLICKS BACK FROM FULLY TIGHTEN

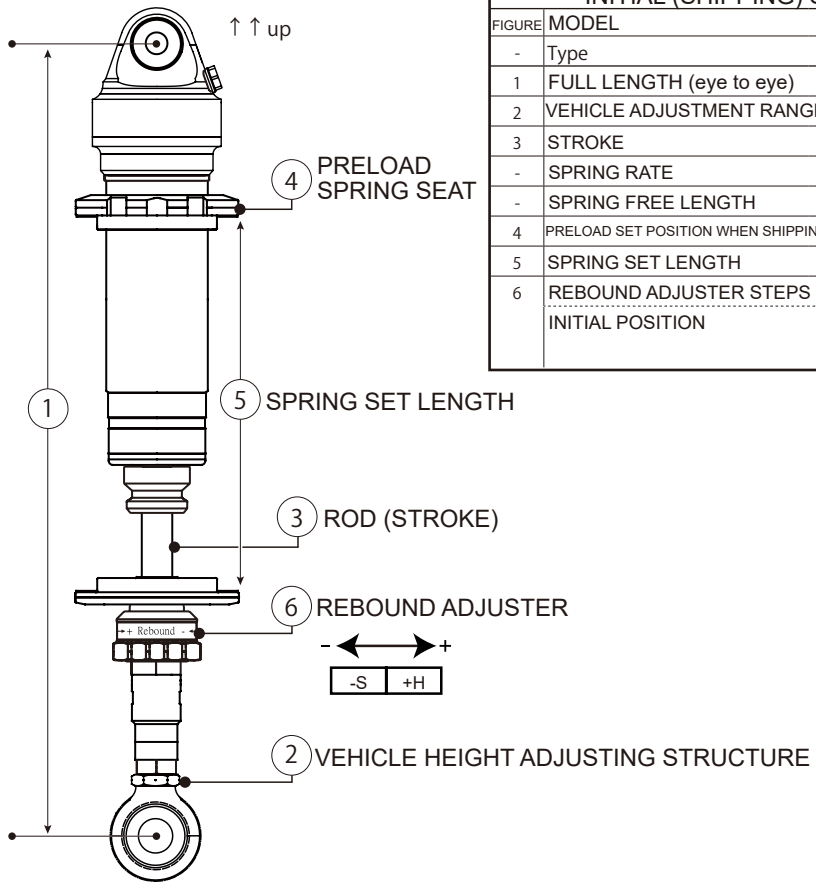

AFTER MAINTENANCE



- Due to the structural principle of suspension, wear and oil deterioration progress in proportion to use. It is able to use longer with original performance for proper overhaul by specialist.
- Please ask to Kitaco when overhauling.