

BIG FOOT (BRAKE PEDAL)

APPLICATION: MONKEY125 (JB02)/GROM(JC61/75/92)

CODE (BLUE) 516-1300910 (RED) 516-1300920 (GOLD) 516-1300970

● Thank you for purchasing Kitaco product. Read and understand the instruction before installing.

■ ATTENTIONS (MUST READ)

- BIG FOOT is dress-up parts. Not for other use.
 - Drive carefully as Kitaco big foot shape is different from genuine pedal.
 - This instruction sheet is for the instruction with genuine condition. Refer to the manufacturer HONDA service manual when installation.
 - BIG FOOT is designed and made exclusive for MONKEY 125,GROM, do not use on other models.
 - Do not modify the way which is not listed or it will cause damage and trouble.
 - We are not responsible for violation of law or damages and accidents caused by assembling mistake and improper setting.
 - Please ask authorized mechanic for assembling and setting. Ask a specialist at specialty shop if you do not understand the role of the surrounding parts.
 - Please check and make sure each part of bolts/nuts are not loose before running.
- ※ Metal/ Resin/ Alumite products get discolored/ rust for ages as well as how to use.

PACKING LIST (Refer to the figures & illustration below)				BLUE	RED	GOLD	REMARK
FIGURE	NAME	CODE	QTY				
1	BRAKE PEDAL BASE	516-1300901	1	1	1	Black	
2	BRAKE PEDAL TOP	Blue	516-1300902BL	1	-	-	
		Red	516-1300902RD	-	1	-	
		Gold	516-1300902GL	-	-	1	
3	BRAKE PEDAL BACK PLATE	516-1300903	1	1	1	Black	
4	WASHER	6x13xT1.0mm	2	2	2		
5	SPRING WASHER	6mm	2	2	2		
6	CAP BOLT	M6x15	4	4	4		
7	FLAT HEAD SCREW	M3x10	2	2	2		

- Change the reusing parts with new ones if there are significant blem, fatigue or wear.
- Adjust big foot base to brake pedal shape when installing.
- Make sure each part is stable and not loosen before actually driving.

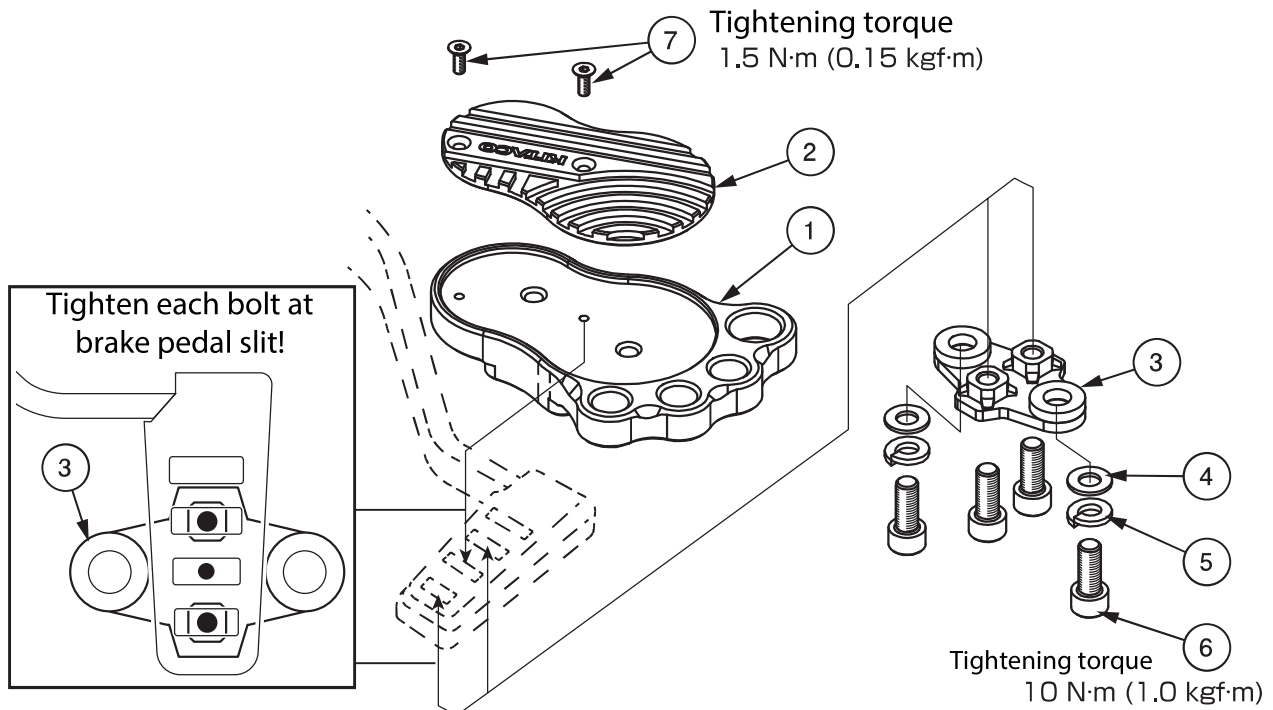

210630 M-T

KITACO
株式会社キタコ

3-8-13
NAGATA, HIGASHI-
OSAKA, OSAKA, 577-0015,
JAPAN