

UNION BAR-END CAP		REMARK : OUTER : ALUMINUM / INNER : STAINLESS STEEL	
CODE	GOLD OUTER : 506-1157210	RED OUTER : 506-1157220	
	BLACK OUTER : 506-1157230	CHROME OUTER : 506-1157240	
APPLICATION	ZOOMER X (JF52) / LEAD125 (JF45 / JK12) / GROM / DUNK (JF74) ●FOR STOCK HANDLE		

●Thank you for purchasing Kitaco product. Read and understand the instruction before installing.

ATTENTION (MUST READ)

- This product is designed and made exclusive for application models, do not use other models. Do not modify the way which is not listed or it will cause damage and trouble.
- We are not responsible for violation of law or damages and accidents caused by assembling mistake and improper setting.
- Please ask authorized mechanic for assembling and setting.
- Refer to the manufacturer service manual when installation.
- Bolts and nuts may get loosen by engine vibration. Make sure not to loosen any bolts and nuts before driving.
- Alumite products get discolored/rust for ages as well as how to use. Please understand when using.

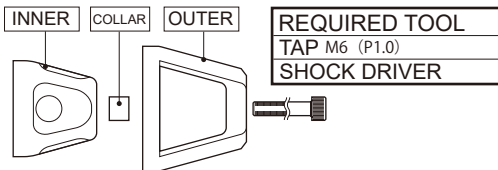

HOW TO INSTALL

- Using shock driver to remove stock bar-end cap because it is difficult to loosen.
- In case of breaking handle side female screw, it needs tapping at M6 screw.
- Install Kitaco bar-end cap with attached bolt in the reverse order of installation and tighten firmly.
- Recommend to apply screw lock to prevent from loosening.

CODE	NAME	QTY
060-0510045	CAP BOLT M6 × 45	× 2
506-1440298	BAR-END CAP COLLAR	× 2
506-1440299	BAR-END CAP INNER	× 2
-	BAR-END CAP OUTER (ALUMITE/CHROME)	× 2

220203 M-T

KITACO
株式会社キタコ

3-8-13 NAGATA,
HIGASHI-OSAKA,
OSAKA, JAPAN