



GRAB BAR	
CODE	(BLACK) 80-653-14520
APPLICATION	GROM (JC92)
REMARK	

Thank you for purchasing Kitaco product. Read and understand the instruction before installing.

ATTENTION (MUST READ)

- This instruction sheet is for the instruction for genuine condition.
- This product is designed and made exclusive for application vehicle, do not use other models. Do not modify the way which is not listed or it will cause damage and trouble.
- We are not responsible for violation of law or damages and accidents caused by assembling mistake and improper setting.
- Please ask authorized mechanic for assembling and setting. Ask a specialist at specialty shop if you do not understand the role of the surrounding parts.
- Refer to the manufacturer service manual when installation.
- Bolts and nuts may get loosen by engine vibration. Make sure not to loosen any bolts and nuts before driving.

 Do not apply excessive force, like rope or tie down belt to deliver vehicle. It may damage this product or surrounding parts.

 Do not apply excessive force, like lift vehicle by using this product. When turning vehicle, please use as support.

PACKING LIST					
FIGURE	NAME		CODE	QTY	REMARK
1	GRAB BAR	BLACK (STEEL)	653-1452101	x1	
2	SPACER COLLAR	9x16xL45	653-1452103	x2	
3	WASHER	8x16xT1.2mm	090-0900008	x4	
4	CAP BOLT	M8x95	080-0500095	x2	TORQUE : 22N·m (2.2kgf·m)
5	SPACER COLLAR	9x16xL30	653-1452102	x2	
6	CAP BOLT	M8x50	080-0500050	x2	TORQUE : 22N·m (2.2kgf·m)

HOW TO INSTALL

- 1) Remove 4 caps of rear side cover.
- 2) Install grab bar with attached bolts and collars to seat rail (cap removed point). (Refer to the illustration below.)
- 3) When installation, tighten the temporarily tightened bolts firmly. Make sure not to loosen any parts before riding.

HOW TO TAKE CARE

Depending on how to use, the rust occurs.

Especially, after riding under the rain or washing, wipe water completely and apply anti-rust, etc.

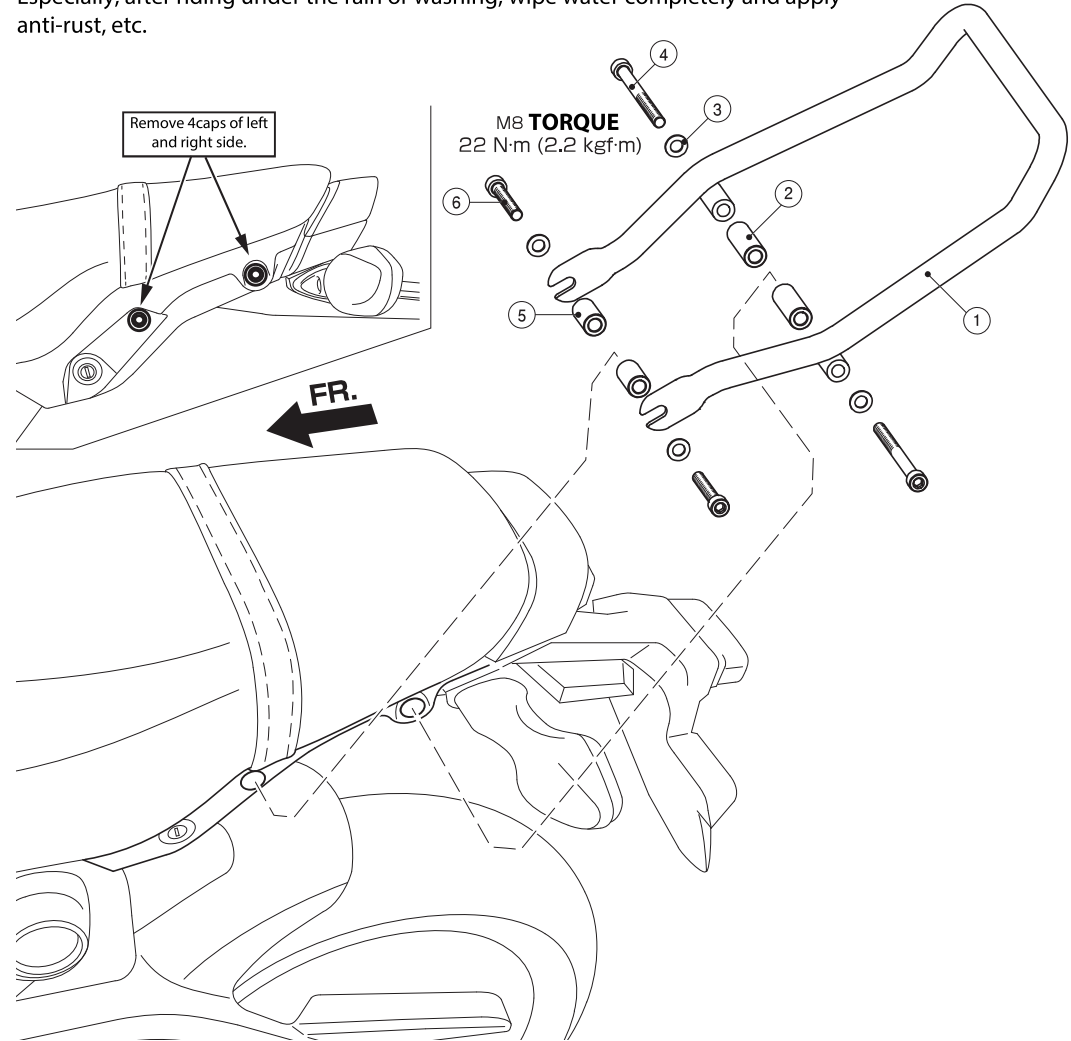

210413 M-H



〒 577-0015
3-8-13

NAGATA, HIGASHI-
OSAKA, OSAKA, JAPAN