

# HANDLE SWITCH (RIGHT SIDE) HAZARD & KILL SWITCH NO,1/2

CODE : 756-1471200

APPLICATION : HUNTER CUB CT125 (JA65)

Thank you for purchasing Kitaco product. Read and understand the instruction before installing.

## ATTENTION (MUST READ)

- This product is designed and made exclusive for application models, do not use other models. Do not modify the way which is not listed or it will cause damage and trouble.
- We are not responsible for violation of law or damages and accidents caused by assembling mistake and improper setting.
- Please ask authorized mechanic for assembling and setting. Ask a specialist at specialty shop if you do not understand the role of the surrounding parts.
- Refer to the manufacturer service manual when installation.
- Please start installation with turn main switch to OFF and head light is completely cooled. It might cause of electric shock and burning.
- Bolts and nuts may get loosen by engine vibration. Make sure not to loosen any bolts and nuts before driving.
- This instruction sheet is for the instruction for stock condition.

| PACKING LIST |                             |                   |             |     |
|--------------|-----------------------------|-------------------|-------------|-----|
| FIGURE       | NAME                        |                   | CODE        | QTY |
| 1            | HANDLE SWITCH ASSY (R SIDE) | CT125 (JA65)      | 756-1471201 | x1  |
| 2            | HARNESS A (for kill switch) | CT125             | 756-1471202 | x1  |
| 3            | HARNESS B (for hazard)      | CT125             | 756-1471203 | x1  |
| 4            | LED WINKER RELAY            | (3P)12v100w       | 755-0400940 | x1  |
| 5            | MS TIE (TIE BAND)           | 152x3.5mm (BLACK) | 700-9200152 | x2  |

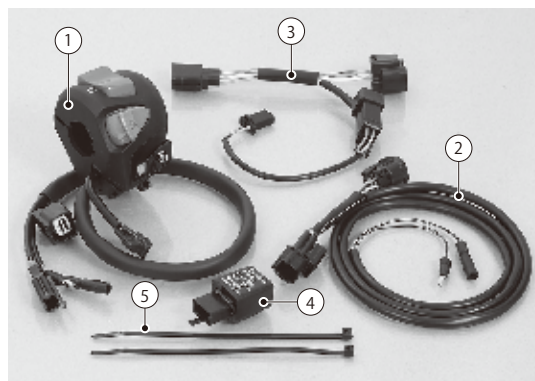

### EACH PARTS NAME AND FUNCTION

1. HAZARD SWITCH (PUSH CANCEL TYPE)

\*Hazard lamp does not flash when key OFF.

2. ENGINE STOP SWITCH  
Basically, push to ○ (Run).  
Push to ⊗ (Stop) when emergency to stop engine.

3. ⚡ STARTER SWITCH

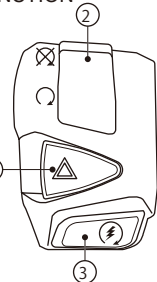

### REMOVING / INSTALLING RIGHT HANDLE SWITCH

1-1 Remove stock parts below.

- R, HANDLE SWITCH (SCREW M5 x 20 : 2pcs)
- THROTTLE CABLE A / B
- WIRE BAND
- BRAKE LIGHT SWITCH WIRE / CONNECTOR

1-2 Install R, handle switch with removed stock parts.  
(Connect brake light switch connector to front stop switch.)

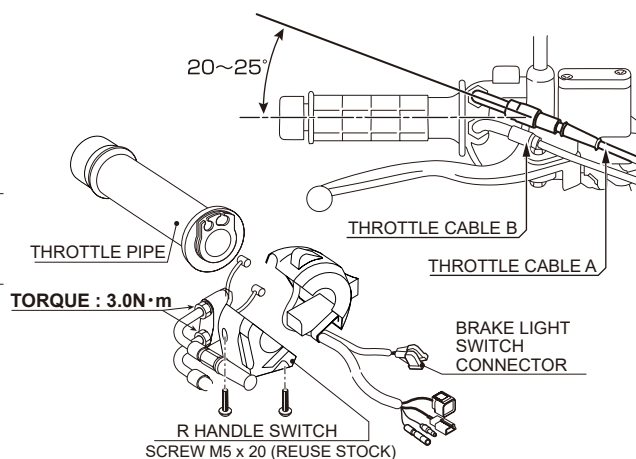

### HARNESS LAYOUT (② HARNESS A)

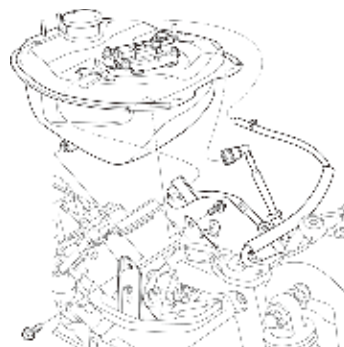

1-1 Remove surrounding outer cowls referring to the service manual to remove or float fuel tank.

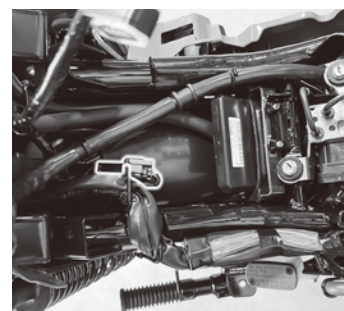

1-2 4P connector under the fuel tank. (Fuel tank has been removed.)

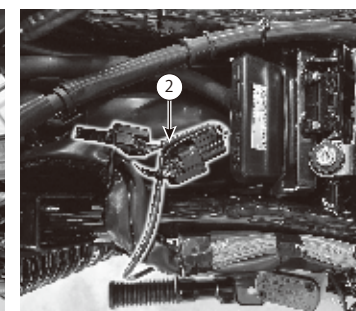

1-3 Insert ② harness A to 4P coupler under the fuel tank.

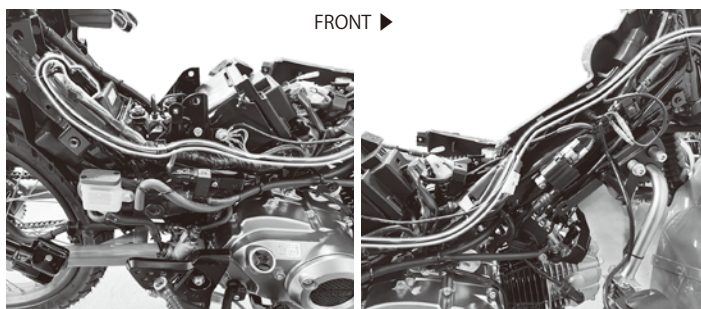

1-4 Route ② harness A to front side with along to other harness.

### WIRING

\*Roll vinyl tape, etc to connecting part for waterproof treatment.

① SWITCH (R) ② HARNESS (A) Insert to vehicle side harness

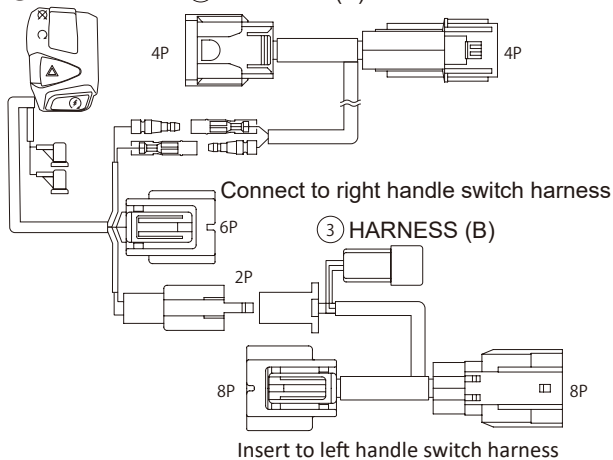

1-5 Change stock winker relay to attached one.

### REAR CENTER COVER

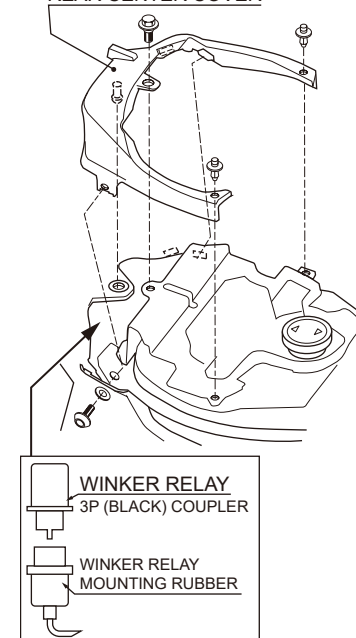

WINKER RELAY  
3P (BLACK) COUPLER

WINKER RELAY  
MOUNTING RUBBER

About winker relay  
Compared to stock, flashing might be different but it is not malfunction.

**HANDLE SWITCH (RIGHT SIDE) HAZARD & KILL SWITCH NO,2/2**

CODE : 756-1471200

APPLICATION : HUNTER CUB CT125 (JA65)

HARNESS LAYOUT ( ① HANDLE SWITCH / ③ HARNESS B )

RIGHT HANDLE SWITCH SIDE

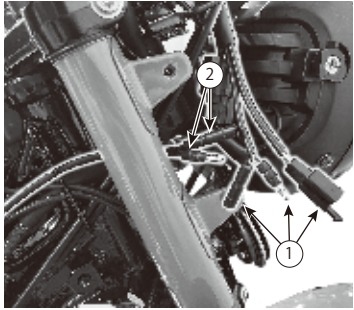

2-1 Connect ① handle switch assy terminal to ② harness A. Connect 6 coupler (female) to right handle switch vehicle side 6P connector. ① 2P connector is right handle switch side.

LEFT HANDLE SWITCH SIDE

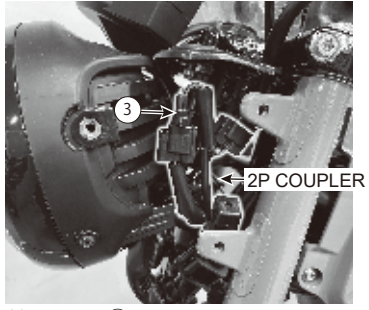

2-2 Insert ③ harness B to left handle switch 8P connector. Route 2P coupler (female) to right side.

RIGHT HANDLE SWITCH SIDE

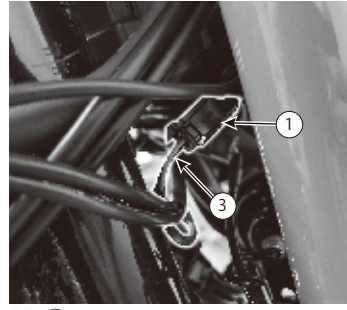

2-3 ① right handle switch 2P connector. ③ 2P connector of harness B insertly connected to left handle switch connector. (Route from left to right side.)

**WIRING CT125 (JA65)**