

STEP BOARD

APPLICATION	Dio110 (JF31)	
CODE	(SILVER ALUMITE) 538-1427000	(BLACK ALUMITE) 538-1427010

●Thank you for purchasing Kitaco product. Read and understand the instruction before installing.

ATTENTION (MUST READ)

- This product is designed and made exclusive for application model, do not use other models. Do not modify the way which is not listed or it will cause damage and trouble.
- We are not responsible for violation of law or damages and accidents caused by assembling mistake and improper setting.
- Please ask authorized mechanic for assembling and setting.
- Refer to the manufacturer service manual when installation.
- Bolts and nuts may get loosen by engine vibration. Make sure not to loosen any bolts and nuts before driving.
- This instruction sheet is for the instruction for stock condition.



There might be burrs on the edge.
Be careful of handling and wear gloves, etc to protect hand when installing.



Due to the material characteristic, it does not deformation freely like rubber sheet. If the curve does not match, process it to install.



Check the bolt tightening again not to forget tightening. (it causes of parts fall and break.)



It might get discolored by ages.
Do not use compound for aluminum or wax.
It may cause of color faded.

PACKING LIST

NAME	QTY
STEP BOARD	× 1
TAPPING SCREW (SUS) M4x14	× 10

HOW TO INSTALL

- Install Kitaco step board temporarily along with stock step board shape.
- ※Patterned surface is upward.
- Making hole with under $\phi 2\text{mm}$ drill to stock step board tapping screw installation position.

ATTENTION

Making hole process by drill may cause of breaking parts under step board, be careful of processing.

- Fix by tapping screw while holding down Kitaco step board.
- Tighten each screw firmly to finish installation.

Making under $\phi 2\text{mm}$ hole process is required.
Refer to the attention.

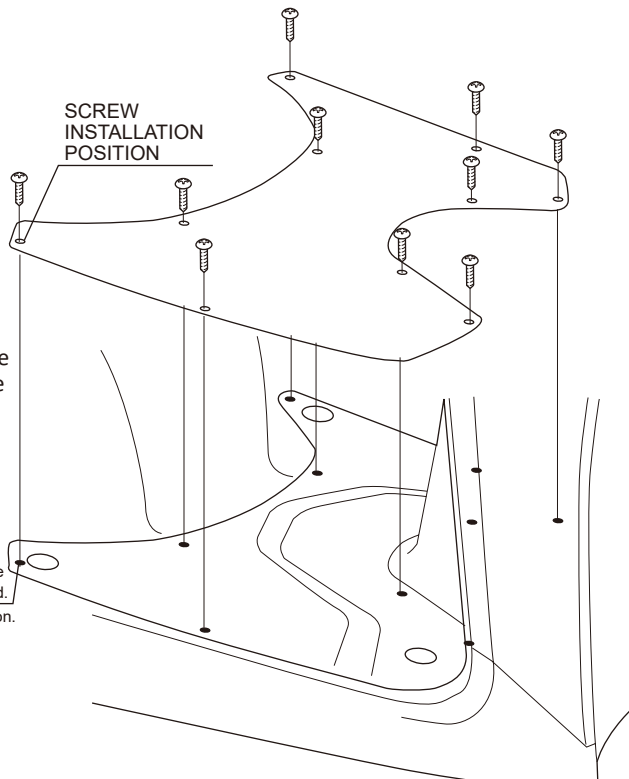

110826 M-T