

HYPER OIL PUMP KIT		CODE : 331-1083600
APPLICATION		
MODELS BELOW WITH ULTRA CLUTCH KIT (the engine with clutch kit is secondary, main shaft side). MONKEY / GORILLA (FNO_Z50J-2000001~/AB27-1000001~1899999) / MONKEY (FI) (FNO,AB27-1900001~) MONKEY BAJA / MONKEY R / RT		
SUPER CUB50(AA04) / SUPER CUB110 / PRO(JA07) / SUPER CUB110(JA10) / CROSS CUB (JA10-4000001~)		
SPEC	OIL AMOUNT : (compared to 50cc carburetor) 2.3 times (compared to CUB50/110 AA04/JA10) 1.4 times *Especially recommend to use with big bore or oil cooler.	

- Thank you for purchasing Kitaco product. Read and understand the instruction before installing.
- There are special tools and gasket set required to install this kit.

ATTENTION (MUST READ)

- Refer to the manufacturer service manual when installation.
- Race use only. Note that racing parts are not covered under warranty.
- We are not responsible for violation of law or damages and accidents caused by assembling mistake and improper setting.
- This product is for increasing oil amount to prevents engine trouble of cooling and oil pressure dropout for better performance.
- Please follow this instruction sheet. Do not modify the way which is not listed or it will cause damage and trouble.
- Please ask authorized mechanic for assembling and setting. Ask a specialist at specialty shop if you do not understand the role of the surrounding parts.
- Bolts and nuts may get loosen by engine vibration. Make sure not to loosen any bolts and nuts before driving.
- This product is designed and made exclusive for application models, do not use other models.



This sheet is intended for the person who has basic knowledge for maintenance. Do not operate if you do not have skill and knowledge.



FLAMMABLES
Inflammable high gasoline is used during operation.



FLAMMABLES
Inflammable high gasoline is used during operation.



Do not touch rotating gear or other rotating parts. Do not rotate tire, etc.



Do not touch the engine parts (cylinder, crankcase, muffler, engine oil, etc) right after engine operation. Make sure to start the installation after the engine parts are completely cool.

HOW TO INSTALL

※ The installation and illustration below is for MONKEY ULTRA CLUTCH KIT installed models. SUPER CUB110(JA07/10) and other models are refer to the service manual when installation.

※ **ORIFICE (OIL ROUTE) EXPANSION PROCESS** (Do not need in case of already processed to $\phi 2.2$ or CUB110 (JA07/10).) To be compatible with oil amount of hyper oil pump, expand to $\phi 2.0$ of the crank case cylinder connecting point oil route (orifice) by using drill.

1 Remove drain bolt in bottom of the engine to take out oil. After taking out, must tighten drain bolt.

2 Remove kick pedal, clutch wire, step, etc to remove right side crank case cover.
In case of changing oil pump spindle, remove engine from vehicle to disassemble crank case.

※ Removing parts are different from model and year, please refer to the manufacturer service manual when installing / removing.

3 Remove 8pcs of M6 bolts from right side crank case. Remove right side crank case cover, gasket and 2pcs of knock pin.

※ In case of difficult to remove, hit lightly with plastic hammer around connecting section ease to remove.

※ In case of stuck gasket to crank case and connecting section, remove with scraper, etc not to scratch connecting section.

4 Remove 3pcs of M6 bolts, stock oil pump and oil pump body gasket. Then change to attached brand new body gasket and Kitaco oil pump.

※ When installation, make sure oil pump drive shaft meshes with oil pump spindle.

※ Spindle collar is not compatible with other than oil pump spindle diameter $\phi 5.5$. Be careful of it.

5 Put the removed parts back together to finish installation. In case of changing spindle, please refer to the manufacturer service manual or big bore kit instruction to install.

※ When installation, please use new right side crank case cover gasket.

6 Make sure that after pouring specified amount of engine oil, there is no oil leak from rotating crank shaft by kick or oil pressure is raised before starting engine. If the oil pressure do not rise, please check assemble.

170619 M-T

※ Illustration is Monkey.
Installation is same as other model and year.

RIGHT SIDE CRANK CASE COVER GK (Use new one)

RIGHT SIDE CRANK CASE COVER

M6 BOLT (TORQUE 10N·m)

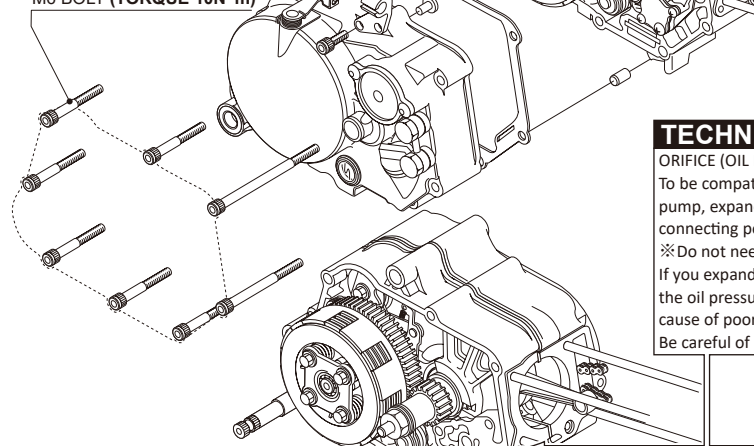

TECHNICAL INFORMATION

ORIFICE (OIL ROUTE) EXPANSION PROCESS

To be compatible with oil amount of hyper oil pump, expand to $\phi 2.0$ of the crank case cylinder connecting point oil route (orifice) by using drill.

※ Do not need for CUB110(JA07/10).

If you expand more than specified diameter, the oil pressure is going to be decreased and cause of poor lubrication.

Be careful of it.

HYPER OIL PUMP

M6 SCREW (STOCK)

TORQUE : 8N·m

SPINDLE COLLAR

※ Only for spindle diameter $\phi 5.5$.

BODY GASKET (Use new one)

M6x25 BOLT (ATTACHED)

TORQUE : 8N·m

See from side, shave the range of dashed line.

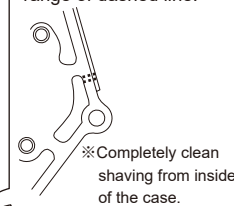

※ Completely clean shaving from inside of the case.

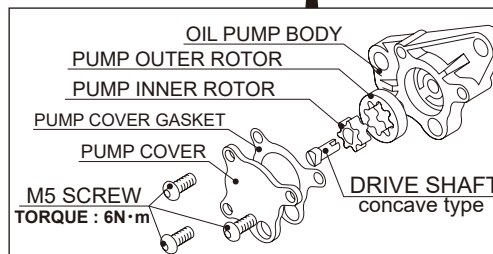

OIL PUMP BODY

PUMP OUTER ROTOR

PUMP INNER ROTOR

PUMP COVER GASKET

PUMP COVER

M5 SCREW

TORQUE : 6N·m

DRIVE SHAFT
concave type

• Install oil pump with matching concave and convex of oil pump drive shaft and oil pump spindle. Do not forget to install collar.

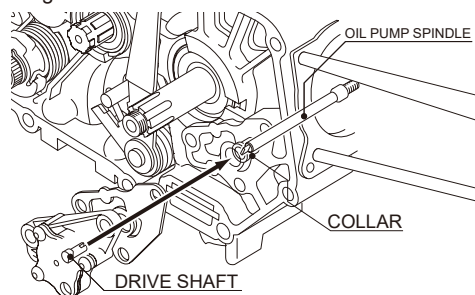

OIL PUMP SPINDLE

COLLAR

DRIVE SHAFT

ELECTRIC DRILL

※ After crank case process, install stud bolt with applying screw lock and tighten with torque 5N·m. By processing case, stud bolt installation point might be thinner, therefore normal torque 12N·m might cause of break.

PACKING LIST

NAME	CODE	QTY
HYPER OIL PUMP BODY	331-1083601	1
OIL PUMP BODY GASKET	966-1015014	1
FLANGE HEXAGON BOLT M6x25	062-0560025	1