

BIG CARBURETOR KIT MIKUNI VM26mm (FOR RACING)

APPLICATION: XR50/CRF50F NO. 110-1129003

● Read and understand the instruction before attaching.

ATTENTIONS (MUST READ)

- This product improves the intake air efficiency and increases output, but you must make the right setting for the engine. It may cause failure, performance deterioration and seizure if you run without setting.
- This carburetor is developed for the vehicles which have big bore greater than STD BIG BORE KIT and attached racing muffler. Setting may not come out if you install to a stock displacement engine.
- Disassembly maintenance is required after using the carburetor to keep best performance.
- KITACO is not responsible for accidents and parts damages by improper setting and assembling mistakes.
- Follow the instructions and attach correctly. Do not modify the way which is not listed, or it may cause seizure and damage.
- Ask a mechanic or a specialist at a specialty shop for assembling and setting if you do not understand the role of the surrounding parts.
- Refer to the HONDA service manual for each vehicle when installing.
- Bolts and nuts may get loosen by engine vibration. Make sure to check each part of bolts and nuts are not loose before running.
- Use genuine parts for setting. (MAIN JETS, PILOT JETS)

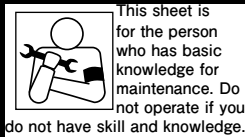

This sheet is for the person who has basic knowledge for maintenance. Do not operate if you do not have skill and knowledge.



FLAMMABLES
Inflammable high gasoline is used during operation. The use of products causing fire or smoke is strictly prohibited.



EXTREMELY HOT
Do not touch the engine parts (cylinder, crankcase, muffler, engine oil, etc...) right after operating. Make sure to start the installation after the engine parts are completely cool.

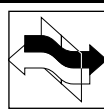

TOXIC
Toxic, highly-volatile gasoline is used during operating. Make sure to ventilate the room and do not operate for hours in a hermetically closed room.

CONTENTS (Check with figures number.)

1	MIKUNI VM26mm CARBURETOR BODY	401-1013003	X1	7	8.5 X 25 X1.6M WASHER	090-0908008	X1
2	HIGH THROTTLE HOLDER SET	901-1015900	X1	8	SPACER COLLAR [R]	093-1129007	X1
	HIGH THROTTLE HANDLE PIPE	901-1015901	X1		MANIFOLD SET CONTENTS		
3	THROTTLE CABLE (PWK)	905-0019014	X1	9	RUBBER HOLDER (VM26)	999-0500201	X1
	VM26 MANIFOLD SET	410-1129003	X1	10	MANIFOLD BODY (VM26) CRF50	100-1129003	X1
	TANK SPACER COLLAR SET	093-1129010	X1	11	MANIFOLD GASKET	950-1015000	X1
4	M8 X 55 CAP BOLT	080-0500055	X1	12	STAINLESS BAND (32 ~ 50)	995-0500050	X2
5	SPACER COLLAR [F]	093-1129006	X1	13	M6 X 20 CAP BOLT	060-0500020	X2
6	M8 X 40 CAP BOLT	080-0500040	X1	14	M6 X 15 CAP BOLT	060-0500015	X2

ABOUT CARBURETOR (How to set when installing carburetor)

SETTING OF CARBURETOR

Carburetor is a part which fuel and air get mixed to make air-fuel mixture. We call this fuel and air mixing rate, "mixing ratio". Basically there are 3 kinds of mixing ratio; lean, appropriate and rich. It is the best to aim appropriate mixing ratio up to full throttle of carburetor setting. You could check the appropriate mixing ratio by "feeling" and "burning condition of spark plug".

※The best setting differs from engine's spec, temperature, atmosphere and humidity.
There are some cases that the setting would go wrong even if you have set it before. For example, by changing exhaust muffler, daytime or night, altitude, seasons or weather.

Check the burning condition by the electrode part.
Black, damp → RICH
White, electrode part is blueish black → LEAN
Golden brown → APPROPRIATE

Start carburetor setting after you break in and when engine warms up. (Run by temporary setting till you finish breaking in the engine.) Test-run in various conditions of throttle from closing to full throttle is required. Set by feeling and checking the burning condition of spark plug.

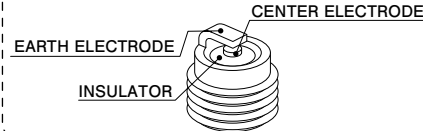

HOW TO INSTALL

▲ This instruction is made for the vehicles which have installed KITACO BIG BORE KIT.

You could not improve if you install to stock engine or LIGHT BIG BORE KIT.

▲ Stock handle bar, stock brake lever, holder and cables are not useable for this kit. Purchase brake lever, holder, cables and kill switch separately.

1. Remove 2 screws of the right side throttle housing, throttle housing, throttle holder and stock throttle cable.

2. Turn the fuel cock OFF, loosen the drain screw of carburetor, drain all gasoline which is inside the carburetor.

※ Use a tray to receive the gasoline as it may spill.

3. Remove the bolt of engine side manifold, bolt of air cleaner, manifold, manifold gasket, stock carburetor and air cleaner.

※ Stock air cleaner box is not useable for this carburetor.

4. Attach the tank spacer collars which are attached to the fuel tank and make sure that it does not interfere with carburetor.

5. Set the throttle holder, throttle housing and throttle cable to the handle bar same way as the stock cable was set.

※ Make sure to grease inside the throttle holder and lubricate inside the throttle housing.

※ Make sure not to set the throttle in wrong direction.

6. Set the throttle cable to the carburetor.

Adjust and assemble completely after you temporarily assemble the manifold gasket, manifold, rubber holder, stainless band and carburetor with the supplied bolt.

※ Make sure to check whether the throttle valve operates smoothly by repeat opening and closing the throttle.

7. Turn the fuel cock ON, start the engine and check whether the engine turns over.

※ Refer to setting manual and make the best setting as this carburetor's setting would change by degree of tuning.

ASSEMBLING CARBURETOR

REMOVING & ATTACHING EXTERIOR PARTS

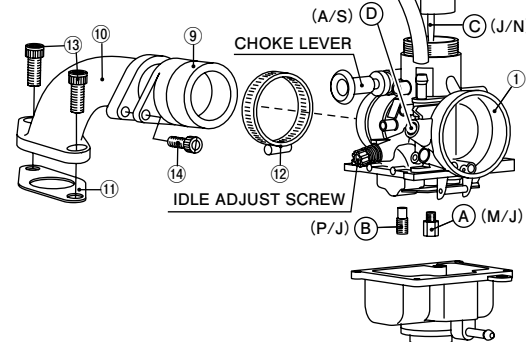
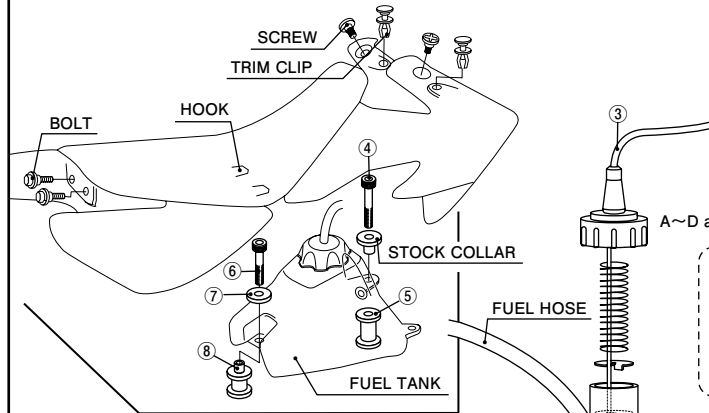

BASIC SETTING

◆ This carburetor's specifications are as follows.

Refer to the setting manual for setting.

The setting parts are available at KITACO.

A. MAIN JET MIKUNI HEX. LARGE

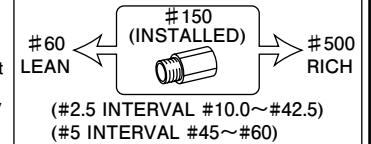

B. PILOT JET MIKUNI SMALL

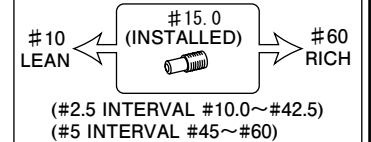

C. JET NEEDLE

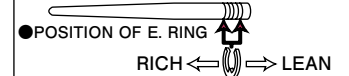

D. AIR SCREW

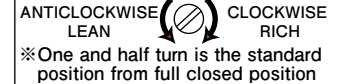

A~D are setting parts.

OVERFLOW

The gasoline overflows as oil surface gets out of control by the dirt and dust which adheres to the float valve in the carburetor. You could easily fix it by cleaning the float valve and removing the dirt and dust.

HOW TO ATTACH HIGH THROTTLE SET (SOLD SEPARATELY)

※Set the wire to the carburetor same way as stock wire was set.

